



Above and below: The Designology house planned for a river frontage property near Seymour.

Not an everyday home

The pictures accompanying this story might look like something out of a futuristic movie, but they couldn't be closer to home — literally.

This is the design for a proposed house overlooking the Goulburn River near Seymour.

It hasn't been built yet — the client was so happy they got the designer to work on something else in inner-city Melbourne first instead — but the design has been shortlisted for a building industry award.

The project, entitled "Seymour Residence", has been nominated for a Best Unbuilt Residential Design Award in the 20th annual Building Designers Association of Victoria Building Design Awards. The awards celebrate Victoria's best building designers across residential design, interior design, heritage conservation, energy efficient design and non-residential design.

This design is being recognised for its innovative design in a rural location, incorporating lightweight design principles and high-tech building solutions. The project is also nominated for the prestigious People's Choice Award, which allows the public to choose their favourite design project. Voting is now open at raw.bdav.org.au and closes on July 13. The award will be presented at the BDAV Annual Dinner on July 25.

So who is behind it, and why?

The design is the brainchild of Docklands-based Designology, run by Kevin Starling.

"It developed from a brief to design and develop an alternative build of a convertible house," Mr Starling told the TELEGRAPH.

"We have a prototype design in Newbury and we've won quite a few awards (BDAV as well as Australian Steel Industry and Housing Industry Asso-

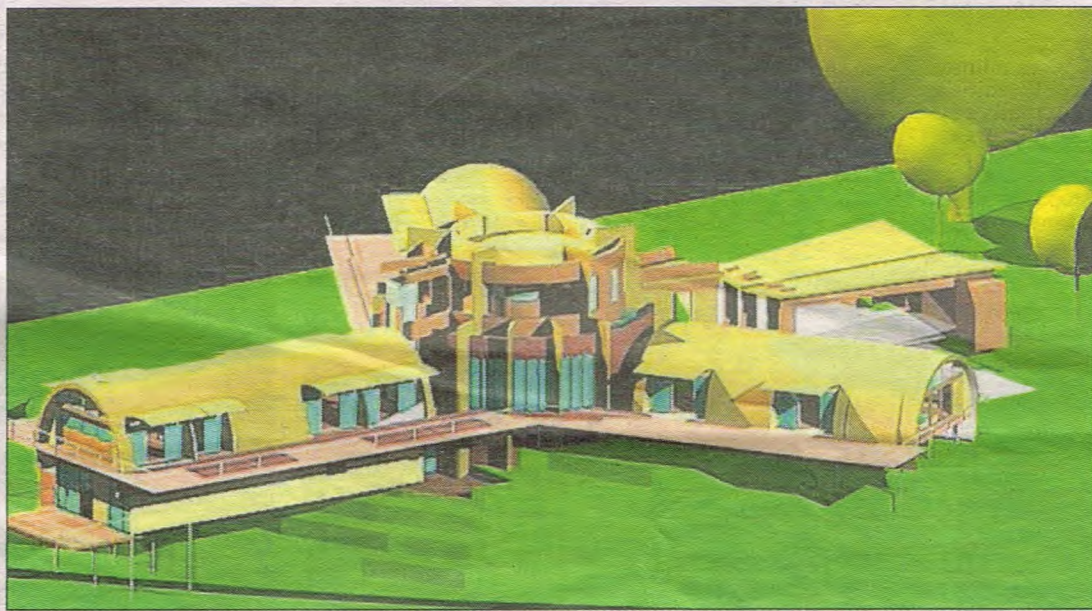

ciation). This particular client saw it and liked the idea of a convertible building, including being able to shut it down.

"We've built about four or five of these but this (version) would've been the biggest."

What this design is made up of is three convertible buildings hanging off a central "circulation space" or a house in itself.

It would have an energy rating of six to seven stars when built, and has awnings which are electrically operated (and can be controlled remotely). It is designed to be particularly effective during times of storms or fire.

"You can shutter the whole house down for security and there's also an airlock between the windows and the outside awning. It also acts as a verandah," Mr Starling said.

What about the shape of the roof?

"It runs longitudinally so (rain) water runs down the sheet and into the gutter which is a slung underbelly (for collection). Debris falls straight off.

"The whole roof also acts as a

thermal chimney. The natural suction effect means (warm) air is pulled up between the ceiling line and roof and it can be collected to be used in the house or purged out the end in summer."

The clients wanted a two-level home, with the lower level for guest accommodation, to include two bedrooms, one bathroom, a wine cellar/storage/bunker and a large living-room with a bar/kitchenette.

The top level was to have two bedrooms with two ensuites, a large kitchen/living/dining area, an alfresco area with barbecue, a study/library, powder-room and laundry/storage area.

Essential items included fire-safe construction, large windows to take in views, larger internal doors and passages for improved accessibility, and rainwater collection.

The central area incorporates living areas that can be partitioned off in various configurations. It also includes the entry and accommodates the stairs and a three-level lift. There is direct access to the

expansive rear deck areas overlooking the valley and river below.

"The client also wanted to be able to use (part of it) as a conference centre," Mr Starling said.

A separate main bedroom wing to the east side of the house has its own retreat area and deck areas to take in the impressive views.

The second wing to the west includes the second bedrooms, bathroom and a rumpus room and deck areas which are interconnected with the main deck areas.

The main wing to the south accommodates the open-plan kitchen/meals/family rooms with expansive deck areas on all sides including an alfresco area with panoramic views on three sides.

So when might it be built?

"All the engineering was done and we lodged a building permit for it," Mr Starling said.

"We're just waiting for the client to push the button."

In brief

NAIDOC week

You can celebrate NAIDOC week in Seymour with the return of a popular event at Lions Park.

The event, from 11 am to 3 pm on July 9, is being held by the Seymour Local Indigenous Network and everyone is invited.

Learn more about NAIDOC week and take part in the activities suited for all ages.

Come and enjoy a free barbecue lunch, live music and free family portraits. The event is drug and alcohol free.

For more information or to RSVP phone Debbie Evans on 0409 185 831 or email deborah.evans@dpc.vic.gov.au

—Ashleigh Paholek

Gun dog challenge

Nagambie will be the scene of an interstate sporting competition with a difference this weekend.

The Working Gundog Association of Australia is holding the North-South Interstate Retrieving Trial Challenge at a property on Wattlevale Rd.

Working gun dogs from Victoria and Queensland will compete in a variety of events on Saturday and Sunday, and will be graded on their skill level.

The trials will start about 8 am each day. The property is about 2 km down Wattlevale Rd (from the Nagambie-Heathcote Rd end) and will be signposted. Everyone attending the site must sign in.

RURAL TYRE SOLUTIONS

Heavy Machinery Specialist

Truck & Tractor

Vulcanising repairs on

damaged tractor tyres.

On site mobile service

Expert service & advice

24 hour call outs

Phone Daniel 0400 985 180



Whatever you're looking for,
you'll find it at
the Yea Country Market.



First Saturday of
every month 9.00am - 2.00pm

Many and varied stalls, the best in fresh local produce, arts and craft, children's activities, playground and skate park. Accompanied by a backdrop of live music, relax and enjoy a latte while taking in the ambiance and fun at this beautiful historic site - Yea Railway Park.

Stalls and Attractions

Freshly baked bread, locally produced olive oils, preserves, wines, soaps and candles. Craft, plants, organic fruit and veg, gourmet sausage sizzle, good old-fashioned egg and bacon rolls and sweet tempting treats! A wonderful day out for the whole family.



YOUR FAVOURITE BUTCHER...

- Great value for money 'Meat Packs' and 'Gourmet Packs' starting from \$50.00
- A variety of Gaffney's family pies.

Drop in and see what's new

- Chicken cutlets, beef volcanos and new range of quality gourmet sausages.

Award Winning Products



Taurus Meats
Butcher & Smokehouse

62 Station St, Seymour 5799 1909