



Shutter  
System  
Overview

6.0

**Verosol**

# Shutter System Overview (page 1 of 2)

Ambience Hardwood Shutters



OPTION

## Single Shutter S212.0, S213.0

W: 400mm - 1050mm  
H: 400mm - 2600mm  
A: 2.7m<sup>2</sup>

Single shutter system includes a shutter only

**Note:** 70mm Blade  
Maximum Width 920mm

### OPTION

L Frame  
Z Frame  
Side Scribes



OPTION

## Hinged Shutter System S212.1, S213.1

W: 400mm - 1050mm  
H: 400mm - 2600mm  
A: 2.7m<sup>2</sup>

Shutter, plus your choice of hirline or pivot hinges (specify colour) and a magnetic catch.

**Note:** 70mm Blade  
Maximum Width 920mm

### OPTION

L Frame  
Z Frame  
Side Scribes  
Hinges

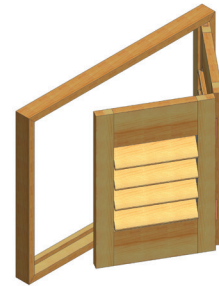
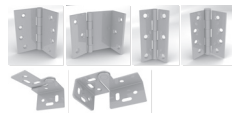

OPTION

## Double Hinged Shutter System S212.2, S213.2

W: 400mm - 600mm  
H: 400mm - 2600mm  
A: 1.56m<sup>2</sup>

Shutter, powder coated top track (white or brown), sliding hardware, pelmet and installation cleat for face fix applications.

### OPTION

L Frame  
Z Frame  
Side Scribes  
Hinges

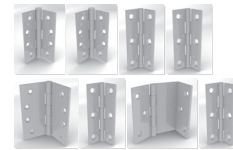

OPTION

## Bi-Fold Shutter S212.3, S213.3

W: 400mm - 650mm  
H: 400mm - 2600mm  
A: 1.69m<sup>2</sup>

Shutter, powder coated top track (white or brown), bi-fold hardware, hirline hinges, pelmet and installation cleat for face fix applications.

### Headboard & Fascia

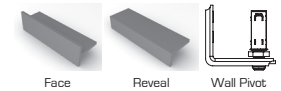

### OPTION

U Chanel Track  
Surface Track

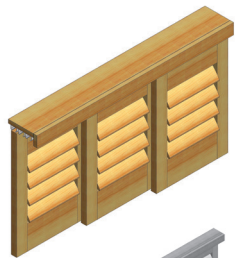

## Sliding Shutter System S212.4, 213.4

W: 700mm - 1050mm  
H: 400mm - 2600mm  
A: 2.7m<sup>2</sup>

Shutter, powder coated top track (white or brown), sliding hardware, pelmet and installation cleat for face fix applications.

### Headboard & Fascia



**Note:** 70mm Blade; Maximum Width 920mm

### OPTION

U Chanel Track  
Surface Track

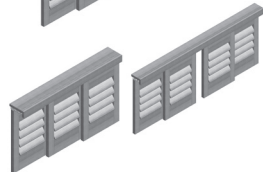

Shutters over maximum widths will be supplied as two panels to be screwed together on site.



OPTION

## Shutter System Overview (page 2 of 2)

### Aluminium Outdoor Shutter

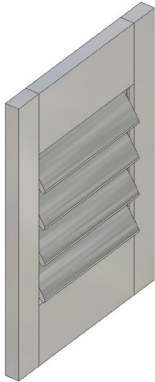

OPTION

#### S211.0 Ambience Aluminium Shutter

W: 400mm - 1200mm  
H: 600mm - 3600mm  
A: 4.32m<sup>2</sup>

(Max area is system dependent)

Shutter and your choice of U Channels, H Channels or T Cover Strip between panels.

#### OPTION

L Frame  
Z Frame

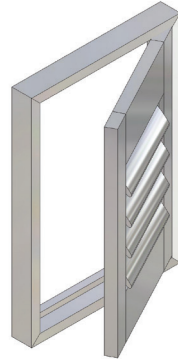

OPTION

#### S211.0 Ambience Aluminium Shutter Hinged Shutter System

W: 400mm - 1200mm  
H: 400mm - 3600mm  
A: 4.32m<sup>2</sup>

Shutter and your choice of Hipline or Pivot hinge in Stainless Steel only, magnetic catch, L or Z section and T Posts.

#### OPTION

L Frame  
Z Frame

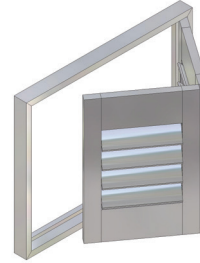

OPTION

#### S211.0 Ambience Aluminium Shutter Double Hinged Shutter System

W: 400mm - 600mm  
H: 400mm - 3600mm  
A: 2.16m<sup>2</sup> [per panel]

Shutter and your choice of Hipline or Pivot hinge in Stainless Steel only, magnetic catch, L or Z section and T Posts.

#### OPTION

L Frame  
Z Frame

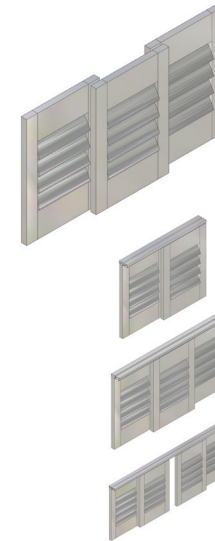

OPTION

#### S211.0 Ambience Aluminium Shutter Sliding Shutter System

W: 700mm - 1200mm  
H: 600mm - 3600mm  
A: 4.32m<sup>2</sup> [per panel]

Shutters, powder coated, (track white or brown) sliding hardware and 90mm L section for fascia.

#### Headboard & Fascia



Aluminium Fascia  
90mm x 50mm

Bottom Track

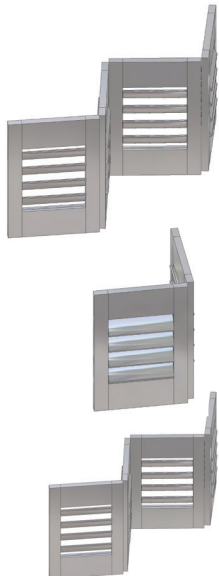

OPTION

#### S211.0 Ambience Aluminium Shutter Bi-Fold Shutter

W: 400mm - 700mm  
H: 600mm - 3600mm  
A: 2.52m<sup>2</sup> [per panel]

**Note:** must be even number of panels

Shutters, powder coated, (track white or brown) bi-folding hardware and 38mm L section for fascia.

#### Headboard & Fascia



Aluminium Fascia  
90mm x 50mm

Bottom Track

notes: